

Kan. Cong. Dist. No. 3

Larry Winn

Form 10-300  
(July 1969)

UNITED STATES DEPARTMENT OF THE INTERIOR  
NATIONAL PARK SERVICE

### NATIONAL REGISTER OF HISTORIC PLACES INVENTORY - NOMINATION FORM

(Type all entries - complete applicable sections)

STATE:	Kansas	
COUNTY:	Miami	
FOR NPS USE ONLY		
ENTRY NUMBER	DATE	

**1. NAME**

COMMON: Miami County Courthouse

AND/OR HISTORIC:

**2. LOCATION**

STREET AND NUMBER: East of the intersection of Miami and Silver Streets

CITY OR TOWN: Paola

STATE	CODE	COUNTY:	CODE
Kansas	66071	Miami	121

**3. CLASSIFICATION**

CATEGORY (Check One)	OWNERSHIP	STATUS	ACCESSIBLE TO THE PUBLIC
<input type="checkbox"/> District <input type="checkbox"/> Site <input type="checkbox"/> Object	<input checked="" type="checkbox"/> Public <input type="checkbox"/> Private <input type="checkbox"/> Both	<input checked="" type="checkbox"/> Occupied <input type="checkbox"/> Unoccupied <input type="checkbox"/> Preservation work in progress	Yes: <input checked="" type="checkbox"/> Restricted <input type="checkbox"/> Unrestricted <input type="checkbox"/> No
PRESENT USE (Check One or More as Appropriate)			
<input type="checkbox"/> Agricultural <input type="checkbox"/> Commercial <input type="checkbox"/> Educational <input type="checkbox"/> Entertainment	<input checked="" type="checkbox"/> Government <input type="checkbox"/> Industrial <input type="checkbox"/> Military <input type="checkbox"/> Museum	<input type="checkbox"/> Park <input type="checkbox"/> Private Residence <input type="checkbox"/> Religious <input type="checkbox"/> Scientific	<input type="checkbox"/> Transportation <input type="checkbox"/> Other (Specify) _____ _____ _____

**4. OWNER OF PROPERTY**

OWNER'S NAME: Miami County

STREET AND NUMBER: Miami County Courthouse  
East of the intersection of Miami and Silver Streets

CITY OR TOWN: Paola

STATE:	CODE
Kansas	20

**5. LOCATION OF LEGAL DESCRIPTION**

COURTHOUSE, REGISTRY OF DEEDS, ETC.: Register of Deeds

STREET AND NUMBER: Miami County Courthouse

CITY OR TOWN: Paola

STATE:	CODE
Kansas	66071

**6. REPRESENTATION IN EXISTING SURVEYS**

TITLE OF SURVEY: NONE

DATE OF SURVEY:  Federal  State  County  Local

DEPOSITORY FOR SURVEY RECORDS:

STREET AND NUMBER:

CITY OR TOWN: STATE: CODE:

SEE INSTRUCTIONS

STATE:	Kansas
COUNTY:	Miami
ENTRY NUMBER	
DATE	

FOR NPS USE ONLY

7. DESCRIPTION

CONDITION	(Check One)				
	<input type="checkbox"/> Excellent	<input type="checkbox"/> Good	<input checked="" type="checkbox"/> Fair	<input type="checkbox"/> Deteriorated	<input type="checkbox"/> Ruins
	(Check One)		(Check One)		
	<input type="checkbox"/> Altered	<input checked="" type="checkbox"/> Unaltered	<input type="checkbox"/> Moved	<input checked="" type="checkbox"/> Original Site	

DESCRIBE THE PRESENT AND ORIGINAL (if known) PHYSICAL APPEARANCE

The Miami County Courthouse at Paola was designed by one of Kansas' best known architects, George P. Washburn. It is Victorian in concept but with extensive Romanesque detailing. The exterior presents much the same appearance today as when it was constructed; however, there is no clock at present in the clock tower at the southeast corner. Some interior remodeling of offices was done in 1958.

Measuring 71 feet wide and 101 feet long, the courthouse is built on a foundation of Carthage limestone extending approximately five feet above the ground. At that point a band of cut stone defines the first floor line. Although the floor plan is basically a square with a tower at each corner, it seems much more intricate because of the varying roof line. The major entry axis is defined by porches on the east and west facades. These porches employ square brick columns with stone bases, capitals, and intermediate bands. The first floor windows are rectangular with stone sills and rough cut lintels that continue around the entire facade to the porches. The second story windows are similar but have a continuous sill. Semicircular windows with arches of stone, or both brick and stone, complete the major fenestration. A sense of unity is developed in the upper story by the continuation of these stone arches in a band effect. This seems to be one of the strongest elements of the design. Even though the structure has several strong horizontal elements, a feeling of balance between vertical and horizontal movement is maintained by numerous vertical lines formed by the towers, slight changes in the wall line, and the shadows resulting from these changes.

The hip roof over the basic square lends itself well to the gable ends and hip roof towers. Even the taller clock tower at the southeast corner of the courthouse falls into place, especially when viewed over the west facade. This building immediately impresses the viewer with its sense of rhythm and balance and the fine stone and brick work is apparent as one moves nearer.

The courthouse presently needs some repair work and the county commissioners have agreed to cooperate with the Miami County Historical Society in planning emergency repairs and subsequently in a complete restoration of the building.

SEE INSTRUCTIONS

**B. SIGNIFICANCE**

PERIOD (Check One or More as Appropriate)

- |  |                                       |  |                                       |
|--|---------------------------------------|--|---------------------------------------|
| <input type="checkbox"/> Pre-Columbian | <input type="checkbox"/> 16th Century | <input type="checkbox"/> 18th Century            | <input type="checkbox"/> 20th Century |
| <input type="checkbox"/> 15th Century  | <input type="checkbox"/> 17th Century | <input checked="" type="checkbox"/> 19th Century |                                       |

SPECIFIC DATE(S) (If Applicable and Known) 1897-1899

AREAS OF SIGNIFICANCE (Check One or More as Appropriate)

- |  |   |  |  |
|--|---|--|--|
| <input type="checkbox"/> Aboriginal              | <input type="checkbox"/> Education              | <input type="checkbox"/> Political           | <input type="checkbox"/> Urban Planning  |
| <input type="checkbox"/> Prehistoric             | <input type="checkbox"/> Engineering            | <input type="checkbox"/> Religion/Philosophy | <input type="checkbox"/> Other (Specify) |
| <input type="checkbox"/> Historic                | <input type="checkbox"/> Industry               | <input type="checkbox"/> Science             | _____                                    |
| <input type="checkbox"/> Agriculture             | <input type="checkbox"/> Invention              | <input type="checkbox"/> Sculpture           | _____                                    |
| <input checked="" type="checkbox"/> Architecture | <input type="checkbox"/> Landscape Architecture | <input type="checkbox"/> Social/Humanitarian | _____                                    |
| <input type="checkbox"/> Art                     | <input type="checkbox"/> Literature             | <input type="checkbox"/> Theater             | _____                                    |
| <input type="checkbox"/> Commerce                | <input type="checkbox"/> Military               | <input type="checkbox"/> Transportation      | _____                                    |
| <input type="checkbox"/> Communications          | <input type="checkbox"/> Music                  |  |  |
| <input type="checkbox"/> Conservation            |   |  |  |

STATEMENT OF SIGNIFICANCE

The Miami County Courthouse at Paola was constructed in 1897-1899 from plans drawn by George P. Washburn of Ottawa, Kansas. Land was purchased for the courthouse site by the county commissioners on April 27, 1897, from M. A. Schroeder for \$4,100. The contract for building the courthouse was let in September, 1897, to L. W. Divelbiss of Olathe, who built a number of Kansas courthouses. By terms of the contract the new courthouse was to be ready by October 1, 1898.

The cornerstone was laid Wednesday, July 27, 1898, during a day long celebration which attracted a crowd of 8,000 to Paola.

On February 1 and 2, 1899, the county commissioners heard from architect Washburn that the contractor, L. W. Divelbiss, was not fulfilling terms of the contract. The commissioners then took steps to relieve him of the work and decided to supervise the finishing projects at the courthouse themselves. County officials apparently moved into the new facility in April, 1899. Cost of the structure is variously given at from \$45,000 to \$90,000.

The Miami County Courthouse is regarded as one of the most outstanding works of George P. Washburn, who was one of the best known 19th century Kansas architects. Courthouses were one of Washburn's specialities, and his symmetrical courthouse designs gave unique character to 13 Kansas county seat towns.

SEE INSTRUCTIONS

9. MAJOR BIBLIOGRAPHICAL REFERENCES

County Courthouses in the State of Kansas (National Society of Colonial Dames in Kansas, 1966).  
Paola Western Spirit, April 30, 1897-April 28, 1899.  
 Wallace, Berenice Boyd, compiler, History of Paola, Kansas (n. p., 1955).

10. GEOGRAPHICAL DATA

LATITUDE AND LONGITUDE COORDINATES DEFINING A RECTANGLE LOCATING THE PROPERTY				O R	LATITUDE AND LONGITUDE COORDINATES DEFINING THE CENTER POINT OF A PROPERTY OF LESS THAN TEN ACRES							
CORNER	LATITUDE				LONGITUDE							
	Degrees	Minutes	Seconds	Degrees	Minutes	Seconds	Degrees	Minutes	Seconds			
NW	°	'	"	°	'	"	38	34	15	94	52	43
NE	°	'	"	°	'	"						
SE	°	'	"	°	'	"						
SW	°	'	"	°	'	"						

APPROXIMATE ACREAGE OF NOMINATED PROPERTY: 1-2 acres

LIST ALL STATES AND COUNTIES FOR PROPERTIES OVERLAPPING STATE OR COUNTY BOUNDARIES

STATE:	CODE	COUNTY	CODE
STATE:	CODE	COUNTY:	CODE
STATE:	CODE	COUNTY:	CODE
STATE:	CODE	COUNTY:	CODE

11. FORM PREPARED BY

NAME AND TITLE: Charles Hall, Architectural Consultant  
 Richard Pankratz, Planner

ORGANIZATION: Kansas State Historical Society DATE: Feb. 18, 1971

STREET AND NUMBER: 120 West Tenth Street

CITY OR TOWN: Topeka STATE: Kansas 66612 CODE: 20

12. STATE LIAISON OFFICER CERTIFICATION

As the designated State Liaison Officer for the National Historic Preservation Act of 1966 (Public Law 89-665), I hereby nominate this property for inclusion in the National Register and certify that it has been evaluated according to the criteria and procedures set forth by the National Park Service. The recommended level of significance of this nomination is:

National  State  Local

Name Nyle H. Miller  
 Nyle H. Miller

Title Executive Director, Kansas State Historical Society

Date July 5, 1972

NATIONAL REGISTER VERIFICATION

I hereby certify that this property is included in the National Register.

Chief, Office of Archeology and Historic Preservation

Date \_\_\_\_\_

ATTEST:  
 \_\_\_\_\_  
 Keeper of The National Register

Date \_\_\_\_\_

SEE INSTRUCTIONS



Paola West  
1957  
1,24,000

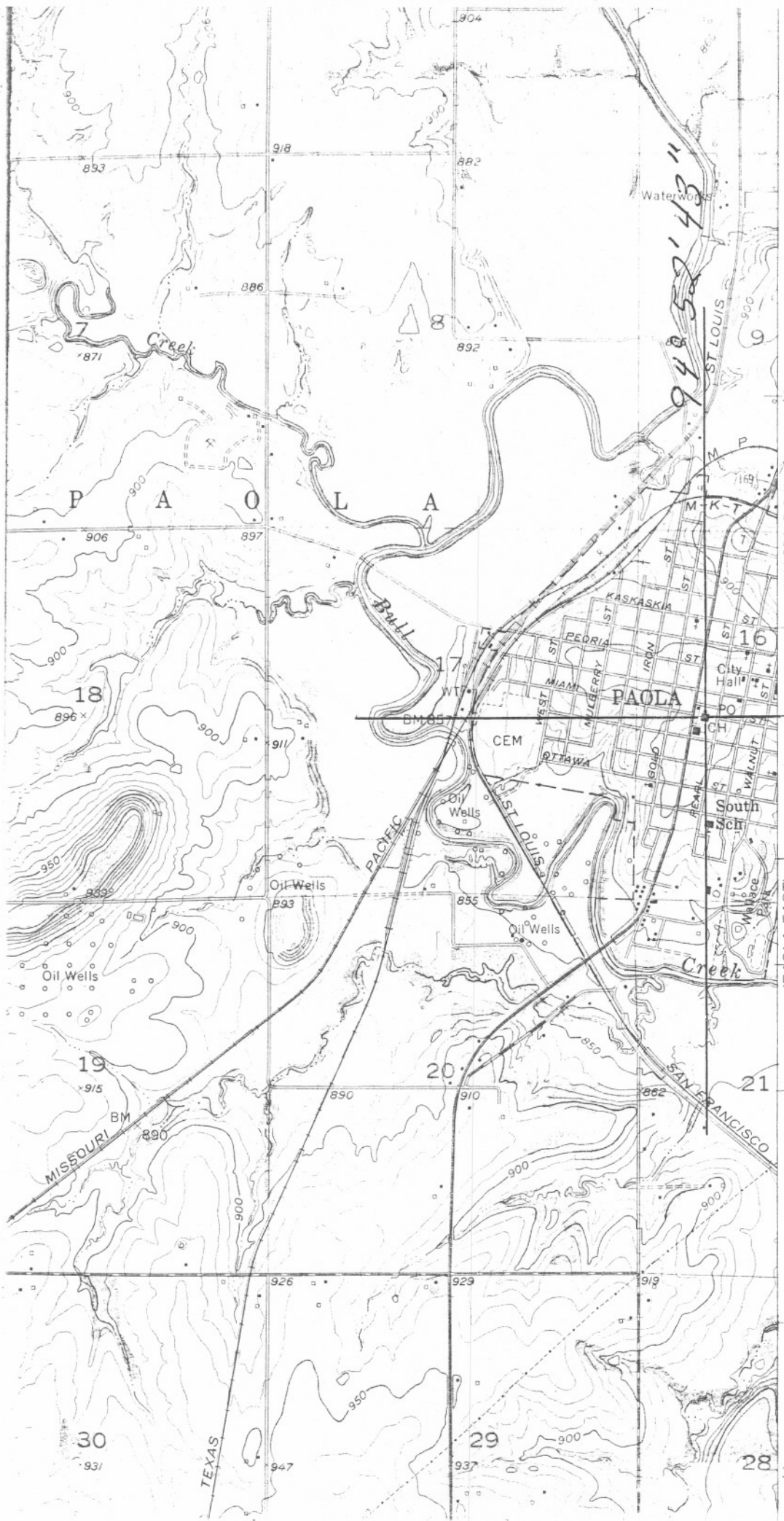

94° 52' 43"

38° 34' 15"

(PAOLA EAST)

32'30"